

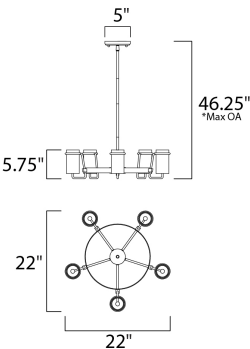

PRODUCT DESCRIPTION

Satin White glass cylinders are cradled in castings of Polished Chrome to create this crisp and clean contemporary design. Each fixture is supplied with xenon lamps for good illumination. High style at an affordable price.



\*max overall height

MEASUREMENTS

DIMENSION : 22" L x 22" W x 5.75" H  
MAX OAH : 46.25" OAH  
CANOPY : 5" W x 0.75" H x 5" L  
HANGING WEIGHT : 7.26 lb  
WIRE LENGTH : 120"

LAMPING

INPUT VOLTAGE : 120V  
LUMENS : 2,450 Rated  
BULB : 5 x 40W Xenon G9 , 200W Total  
BULB INCLUDED : (Included)  
DIMMABLE : Yes

FINISHES OPTION

Polished Chrome

GLASS

Satin White SW

MATERIAL

Steel, Glass

RATINGS

cETLus  
Dry Location



ADDITIONAL

ADJUSTABLE  
RATED LIFE 2000 Hours  
OPERATING TEMPERATURE:  
-20°C (-4°F), 40°C (104°F)

Always consult a qualified electrician before installing any lighting product.



WESTERN DISTRIBUTION CENTER (HEADQUARTER)  
253 NORTH VINELAND AVE | CITY OF INDUSTRY, CA 91746  
EASTERN DISTRIBUTION CENTER  
4200 SHIRLEY DR. | ATLANTA, GA 30336  
P. 626.956.4200 | F. 626.956.4225 | maximlighting.com