

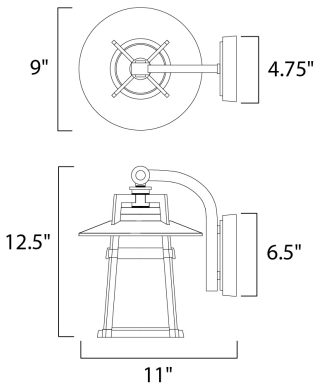

PRODUCT DESCRIPTION

The Calistoga Collection is where classic, yet contemporary, style meets energy efficiency. With a Die Cast aluminum frame constructed in sleek lines and finished in Adobe, this collection features an integral hood with a Satin White conical shade, casting light downward. The collection is also available in LED (Calistoga LED) and Incandescent (Calistoga).



MEASUREMENTS

DIMENSION : 9" W x 12.5" H x 11" Ext
BACK PLATE : 4.75" W x 6.5" H x 6.5" HCO
HANGING WEIGHT : 3.96 lb

LAMPING

INPUT VOLTAGE : 120V
LUMENS : 1,355 Rated
BULB : 1 x 18W Fluorescent GU24 , 18W Total
BULB INCLUDED : (Included)
DIMMABLE : No
COLOR_TEMP : 2700K

FINISHES OPTION

Adobe

GLASS

Satin White SW

MATERIAL

Die Cast Aluminum

RATINGS

Wet Location



ADDITIONAL

RATED LIFE 10000 Hours
OPERATING TEMPERATURE:
-20°C (-4°F), 40°C (104°F)

Always consult a qualified electrician before installing any lighting product.



WESTERN DISTRIBUTION CENTER (HEADQUARTER)
253 NORTH VINELAND AVE | CITY OF INDUSTRY, CA 91746
EASTERN DISTRIBUTION CENTER
4200 SHIRLEY DR. | ATLANTA, GA 30336
P. 626.956.4200 | F. 626.956.4225 | maximlighting.com