

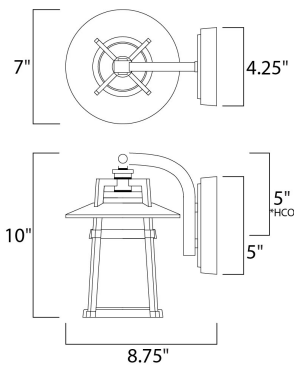

PRODUCT DESCRIPTION

Classic, contemporary style of Die Cast aluminum finished in Adobe features an integral hood and Satin White conical shade, which help cast light in a downward direction. Illumination provided by long life and energy efficient LED.



MEASUREMENTS

DIMENSION : 7" W x 10" H x 8.75" Ext  
BACK PLATE : 4.25" W x 5" H x 5" HCO  
HANGING WEIGHT : 2.71 lb

LAMPING

INPUT VOLTAGE : 120V  
LUMENS : 360 Rated  
BULB : 1 x 4W LED PCB Integrated , 4W Total  
BULB INCLUDED : (Integrated)  
DIMMABLE : Triac CL  
CRI : 90+ CRI  
COLOR\_TEMP : 3000K

FINISHES OPTION

Adobe

GLASS

Satin White SW

MATERIAL

Die Cast Aluminum, Glass

RATINGS

cETLus  
Wet Location  
For Outdoor



ADDITIONAL

RATED LIFE 40000 Hours  
OPERATING TEMPERATURE:  
-20°C (-4°F), 40°C (104°F)

PHOTOMETRIC: Report Found Online

Always consult a qualified electrician before installing any lighting product.



**WESTERN DISTRIBUTION CENTER (HEADQUARTER)**  
253 NORTH VINELAND AVE | CITY OF INDUSTRY, CA 91746  
**EASTERN DISTRIBUTION CENTER**  
4200 SHIRLEY DR. | ATLANTA, GA 30336  
P. 626.956.4200 | F. 626.956.4225 | maximlighting.com