

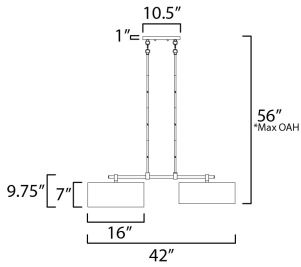

PRODUCT DESCRIPTION

A collection of drum shade lighting available in your choice of Oatmeal with Natural Aged Brass or Oil Rubbed Bronze or White Linen with Satin Nickel frames. This transitional design works in a wide variety of decor styles from traditional to contemporary and available in multiple configurations from flush mounts, pendants, wall sconces, and linear bar lighting.



*max overall height

MEASUREMENTS

- DIMENSION : 42" L x 16" W x 9.75" H
- MAX OAH : 56" OAH
- CANOPY : 4.75" W x 1" H x 10.5" L
- HANGING WEIGHT : 7.1 lb

LAMPING

- INPUT VOLTAGE : 120V
- BULB : 2 x 60W Incandescent E26 Medium , 120W Total
- BULB INCLUDED : (Not Included)
- DIMMABLE : Y

FINISHES OPTION

- Natural Aged Brass (NAB)
- Oil Rubbed Bronze (OI)
- Satin Nickel (SN)

MATERIAL

Steel, Linen, Acrylic

RATINGS

cETLus
Dry Location



ADDITIONAL

SLOPE: 70
OPERATING TEMPERATURE:
-20°C (-4°F), 40°C (104°F)

Always consult a qualified electrician before installing any lighting product.



WESTERN DISTRIBUTION CENTER (HEADQUARTER)
253 NORTH VINELAND AVE | CITY OF INDUSTRY, CA 91746

EASTERN DISTRIBUTION CENTER
101 GARDNER PARK | PEACHTREE CITY, GA 30269

P. 626.956.4200 | F. 626.956.4225 | maximlighting.com