

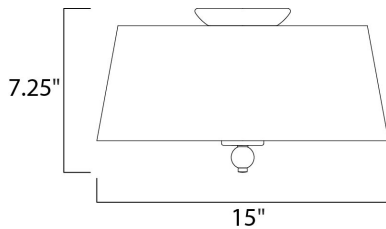

PRODUCT DESCRIPTION

Exemplary transitional styling, the Rondo collection takes a classic shaded design and updates it with contemporary finishes and delightful glass orb details. The sharpness of the Polished Nickel frame is softened with the use of round crystal glass balls. The White hardback fabric shades are fit with frosted diffusers so the light is even and soft while concealing the bulb.



MEASUREMENTS

DIMENSION : 15" L x 15" W x 7.25" H
HANGING WEIGHT : 2.9 lb

LAMPING

INPUT VOLTAGE : 120V
BULB : 3 x 60W Incandescent E26 Medium , 180W Total
BULB INCLUDED : (Not Included)
DIMMABLE :

FINISHES OPTION

 Polished Nickel (PN)

GLASS

White WT

MATERIAL

Steel, Fabric, Glass, Acrylic

RATINGS

cULus
Dry Location



ADDITIONAL

OPERATING TEMPERATURE:
-20°C (-4°F), 40°C (104°F)

Always consult a qualified electrician before installing any lighting product.