

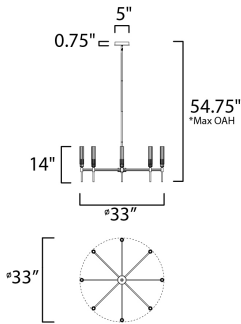

PRODUCT DESCRIPTION

Dramatic and opulent, light sources shine through exquisite Clear scalloped glass hurricane shades as they seemingly float on unique metal prongs finished in Antique Brass. The brass accents are contrasted with a Black frame configured in cascading pendant forms, classically tiered chandeliers and elongated individual pendants. The expansive variety of configurations present a configuration for all the interior spaces of a home, be it over dining tables or used in the entry, kitchen, or over the vanity. The collection also includes ADA wall sconces that are left and right oriented for symmetrical installations bedside or beside a mirror.



\*max overall height

MEASUREMENTS

DIMENSION : 33" L x 33" W x 14" H  
MAX OAH : 54.75" OAH  
CANOPY : 5" W x 0.75" H x 5" L  
HANGING WEIGHT : 12.98 lb

LAMPING

INPUT VOLTAGE : 120-277V  
LUMENS : 920 Rated  
BULB : 8 x 1.8W LED 12V G4 , 14W Total  
BULB INCLUDED : (Included)  
DIMMABLE : ELV at 120V, 0-10V  
CRI : 90 CRI  
COLOR\_TEMP : 3000K

FINISHES OPTION

 Black / Antique Brass (BKAB)

GLASS

Clear CL

MATERIAL

Glass, Steel

RATINGS

cETLus  
Dry Location



ADDITIONAL

SLOPE: 90  
RATED LIFE 35000 Hours  
OPERATING TEMPERATURE:  
-20°C (-4°F), 40°C (104°F)

Always consult a qualified electrician before installing any lighting product.



WESTERN DISTRIBUTION CENTER (HEADQUARTER)  
253 NORTH VINELAND AVE | CITY OF INDUSTRY, CA 91746  
EASTERN DISTRIBUTION CENTER  
101 GARDNER PARK | PEACHTREE CITY, GA 30269  
P. 626.956.4200 | F. 626.956.4225 | maximlighting.com