

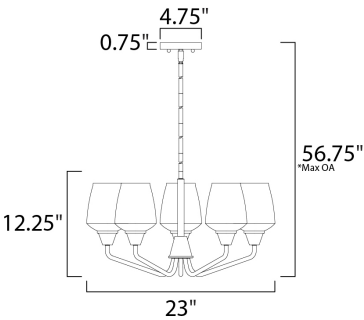

PRODUCT DESCRIPTION

Simple yet elegant frames are finished in two tone finishes to add upscale element to this economical collection. Frames are available in either Bronze with Antique Brass accents or Black with Satin Nickel accents. Both are supplied with Clear glass shades inspired by stemware for a tailored profile.



\*max overall height

MEASUREMENTS

DIMENSION : 23" L x 23" W x 12.25" H  
MAX OAH : 56.75" OAH  
CANOPY : 4.75" W x 0.75" H  
HANGING WEIGHT : 5.6 lb

LAMPING

INPUT VOLTAGE : 120V  
BULB : 5 x 60W Incandescent E26 Medium , 300W Total  
BULB INCLUDED : (Not Included)  
DIMMABLE :

FINISHES OPTION

- Black / Satin Nickel (BKSN)
- Bronze / Antique Brass (BZAB)

GLASS

Clear CL

MATERIAL

Steel, Glass

RATINGS

cULus  
Dry Location



ADDITIONAL

ADJUSTABLE  
SLOPE: 120  
OPERATING TEMPERATURE:  
-20°C (-4°F), 40°C (104°F)

Always consult a qualified electrician before installing any lighting product.



WESTERN DISTRIBUTION CENTER (HEADQUARTER)  
253 NORTH VINELAND AVE | CITY OF INDUSTRY, CA 91746  
EASTERN DISTRIBUTION CENTER  
101 GARDNER PARK | PEACHTREE CITY, GA 30269  
P. 626.956.4200 | F. 626.956.4225 | maximlighting.com