

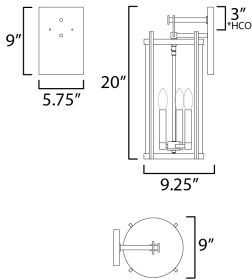

PRODUCT DESCRIPTION

Squared columns in Matte Black finish tower above the cylindrical glass shade rated for outdoor applications. Available in a more modern clear glass option or hammered glass. A rectangular hook detail carries the square form through to the backplate. A modern interpretation of a bell tower, these outdoor pendants and sconces are a cleaned up, transitional look for exteriors.



*Height from center of outlet to the top of the fixture

MEASUREMENTS

DIMENSION : 9" W x 20" H x 9.25" Ext
MAX OAH : 5.75" W x 9" H
HANGING WEIGHT : 8.14 lb

LAMPING

INPUT VOLTAGE : 120V
BULB : 3 x 40W Incandescent E12 Candelabra , 120W Total
BULB INCLUDED : (Not Included)
DIMMABLE :
LIGHTING_DIRECTION : Up

FINISHES OPTION

Black (BK)

GLASS

Clear CL

MATERIAL

Aluminum, Glass

RATINGS

cETLus
Wet Location



ADDITIONAL

INSTALL UP/DOWN: Up
OPERATING TEMPERATURE:
-20°C (-4°F), 40°C (104°F)

Always consult a qualified electrician before installing any lighting product.



WESTERN DISTRIBUTION CENTER (HEADQUARTER)
253 NORTH VINELAND AVE | CITY OF INDUSTRY, CA 91746
EASTERN DISTRIBUTION CENTER
101 GARDNER PARK | PEACHTREE CITY, GA 30269
P. 626.956.4200 | F. 626.956.4225 | maximlighting.com